

TRAVELING RESPONSIBLY:

- ▶ The driver **MUST** quote your exact fare upon request. If there is a radio, the driver **MUST** get a quote from the dispatcher if you ask them to.
- ▶ The driver **MUST** provide a detailed receipt upon request.
- ▶ There is **NO** surcharge for property up to 50 pounds as well as no charge for equipment for the disabled.
- ▶ The taxi **MUST** have their taxicab medallion, their taxi (or “hack”) license and zone maps prominently displayed.
- ▶ Refusing to pay the fare is a misdemeanor punishable by a fine of up to \$1000 and/or up to a year in jail.
- ▶ The taxi cab is the driver’s place of business. A pleasant demeanor on your part will go a long way to insuring a stress free ride. Any damage made in or to a taxi will probably end business for the driver for the night.

TAXI SAFETY TIPS:

- ▶ Only accept a ride in a vehicle that is clearly identified as a taxi by outside markings, insignias or names. Never get into an unmarked vehicle.
- ▶ Do not accept a ride from a driver who tries to pack in more riders than there are seatbelts. (4-5 in a sedan, 7 in a van.)

COMPLAINTS:

To file a complaint regarding taxi service in the City of Albany, contact the Albany Police Department’s Traffic Safety Division at 518-458-5675 with the taxi company’s name, taxi number, the driver’s name and the date and time of service.

SPECIFIC RATE EXAMPLES:

Four students traveling from Zone A (where the bus station is located) to the same residence quadrangle/apartment complex uptown (State, Colonial, Dutch, Indian or Empire Commons – Zone F) would pay \$6.25 for the first person and \$1.50 each for the other three riders (unless it is between 6:00 p.m. and 6:00 a.m. every day and for a 24 hour period on Sundays and holidays and then a \$1.00 surcharge per destination is added to the total amount). Freedom Quadrangle is in Zone G and the first person traveling here would pay \$6.25.

If a taxi traveling from the bus station drops at more than one residence quadrangle/apartment complex, for example two students to Dutch Quadrangle and two students to Indian Quadrangle, the two students to Dutch would pay \$6.25 and \$1.50 for a total of \$7.75 (unless the previously noted \$1.00 surcharge per destination applies) and the two to Indian would also pay \$6.25 and \$1.50 for a total of \$7.75 (unless the previously noted \$1.00 surcharge per destination applies).

T.R.I.P **TAXI RIDER’S** **INFORMATION PROGRAM**



LEARN: **RATE INFORMATION** **RESPONSIBILITIES**

Office of Personal Safety and Off-Campus Affairs
University Police Department



STUDENT SUCCESS

UNIVERSITY AT ALBANY

State University of New York

CALCULATE YOUR TAXI FARE BASED ON THE REGULATIONS BELOW:

TAXICAB RATES IN THE CITY OF ALBANY ARE BASED ON A ZONE SYSTEM. ACCORDING TO THE MAP BELOW, TRAVELING WITHIN A ZONE CARRIES THE BASE RATE INDICATED. TRAVELING BETWEEN ZONES CARRIES THE HIGHER OF THE TWO ZONES' BASE RATE.

EXCEPTIONS:

- ▶ The airport and train station are not in the City of Albany so rides to and from these places are not covered under the zone system.
- ▶ Traveling between zones B or C and zone D add \$0.75.
- ▶ Traveling between zones B or C and zone E add \$1.25.
- ▶ Traveling between zones B or C and zones F or G add \$2.50.
- ▶ Traveling between B and C has a base rate of \$9.75.
- ▶ Traveling east from zone G further than F has a base rate of \$11.25.

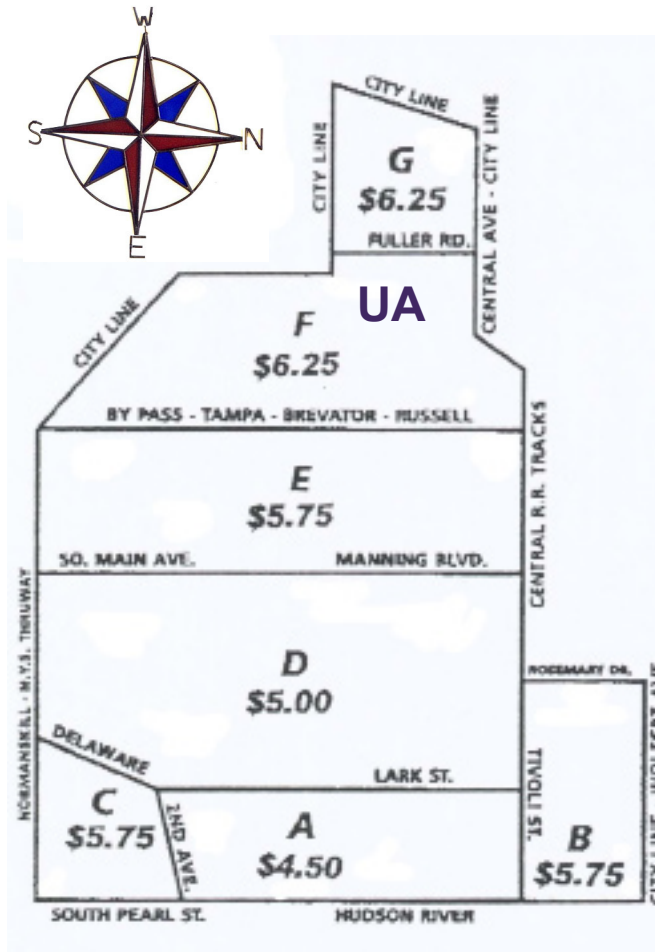

SURCHARGES:

- ▶ From 6PM to 6AM and all day on Sunday and holidays a \$1.00 surcharge will be added.
- ▶ If a taxi is waiting more than 15 minutes there is a \$5.00 surcharge. An additional \$5.00 can be added for each additional 15 minutes.

ADDITIONAL PASSENGERS:

- ▶ Additional passengers carry a \$1.50 per person charge.
- ▶ When traveling to different destinations (ie, different quadrangles/apartment complexes) each destination is considered a different stop/a new base rate. Each additional person to a destination is an extra \$1.50.

SEE THE BACK OF THIS BROCHURE FOR SPECIFIC RATE EXAMPLES