

# UPTOWN CAMPUS

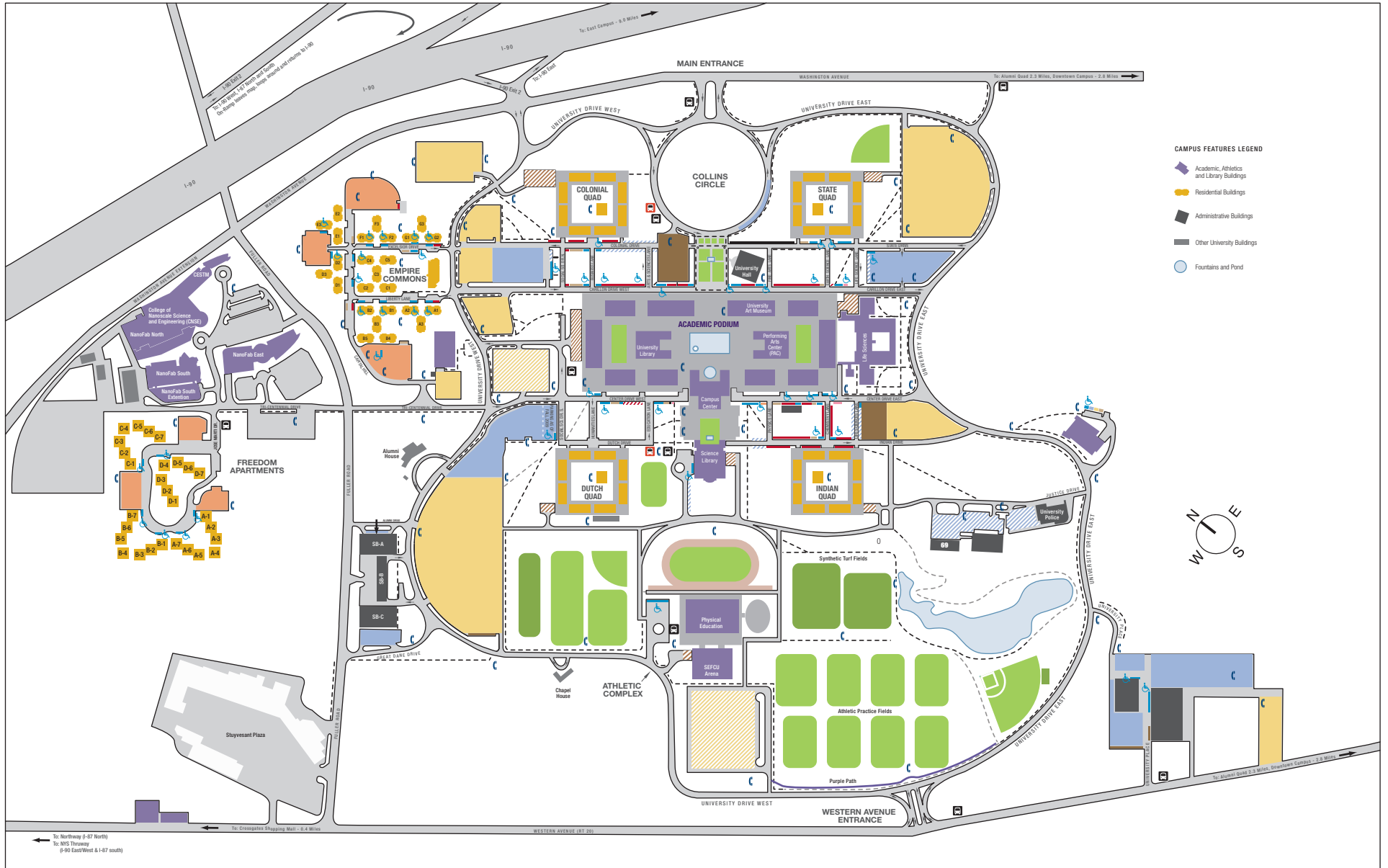

- CAMPUS FEATURES LEGEND**
- Academic, Athletics and Library Buildings
  - Residential Buildings
  - Administrative Buildings
  - Other University Buildings
  - Fountains and Pond



**PARKING, TRANSPORTATION AND PEDESTRIAN WALKWAY LEGEND**

- Visitor Parking  
8:00AM-8:00PM Monday-Friday  
Visitors must park in visitor parking or at metered parking spaces
- Student Permit Required  
24 Hours - Everyday
- Faculty/Staff Permit Required  
8:00AM-4:00PM
- Special Permit Required  
24 Hours - Everyday
- Pedestrian Path - Paved
- Student Permit Required  
8:00AM-12:00AM Everyday (No Overnight)
- Faculty/Staff Permit Required  
24 Hours - Everyday
- Special Permit Required  
8:00AM-4:00PM - Everyday
- Pedestrian Path - Unpaved
- Student Empire Commons or Freedom Apartments Permit Required  
24 Hours - Everyday
- Reserved
- Special Dock Permit Required
- Bus Stop
- University Handicap Permit Required
- Shuttle to Health & Counseling Services, Patton Creek
- Emergency Bluelight Phone
- Ropes Course

**Note:** Students may park in any available Student Permit Required parking areas except for Empire Commons and Freedom Apartments parking areas. Also, please note that all parking is subject to change. Therefore, please pay attention to parking signage.